



MARCO's Successful Fast-Track Project for Saudi Industrial Development Fund

PJW8+RFC. Northern Ring Branch
Road, An Nakhil, An Nakheel, Riyadh
12391, Saudi Arabia

<https://www.mrtc.com.sa>

The Details

Client: Saudi Industrial Development Fund

Consultant: Q Design

Contractor: MARCO

Location: Riyadh

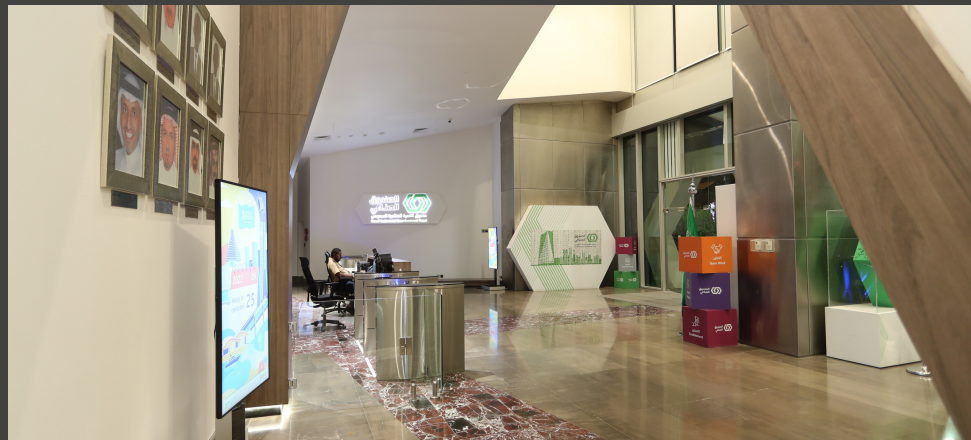

A photograph of a modern office lounge area. The room features two light blue sofas arranged around a dark wooden coffee table. The walls are decorated with vertical green living walls. Large windows in the background offer a view of a city skyline at dusk. The ceiling has a dark, geometric design with recessed lighting. A large potted plant is visible near the windows. The image is framed by a large, stylized green and grey geometric shape on the left side.

About The Project

The Saudi Industrial Development Fund (SIDF) was seeking a reliable contractor for the fit-out works at its headquarters to support the transformation of the industrial sector in Saudi Arabia. The project had a fast-track execution schedule with strict deadlines, as the client needed to host an event at the new headquarters within a few months of the project commencement date.

The project involved turnkey fit-out works at Parcel 3.04 SIDF headquarters, with a total built-up area of 25,205 m², encompassing architectural finishes, mechanical, electrical, and communication works. The 32-story tower was divided into four major groups, each with distinct functions, requiring extensive and diverse work streams. It was essential to hire the right contractor, one that could mobilize quickly, focus on the details, and provide the results that SIDF needed.

Project Brief



The Challenge

The appointed contractor had to deliver and furnish the project within the tight deadline, requiring reliability, attention to detail, and a commitment to project success. MARCO's technical proposal, which demonstrated our skills in studying and planning, offered the quickest procurement plan, a dedicated attention to details, and a competitive price, making it the best choice for the project.

Choosing MARCO

With a tight deadline, there wasn't time to waste on a contractor who couldn't deliver results. We presented a technical submittal that emphasized our ability to quickly mobilize. We also offered a competitive price, and showcased a history of successful projects. We were also engaged with the owner at the earliest stages of the project, even before submitting a bid, showing that our leadership was committed to the client's success.



Our Approach

MARCO's leadership worked closely with the client's side to understand their requirements and concerns. MARCO assigned a professional procurement team to derive the best plan for all materials to be delivered on time. MARCO's leadership played an important role in communicating the employer's requirements with the construction team. The owner was impressed with MARCO's leadership being reachable at any time to cooperate on delivering the project successfully.



Project Implementation

MARCO's leadership worked closely with the clients to understand their requirements and concerns. They assigned a professional procurement team to derive the best plan for all materials to be delivered on time, and they played an important role in communicating the employer's requirements with the construction team. The scope of work for this project included:

- Demolition work, Masonry work, Metal work, Wood & plastics
- Thermal & moisture protection, Openings, Finishing, Specialties
- Furnishings, Fire suppression, Plumbing, HVAC, Integrated Automation
- Electrical, Communication, Electronic Safety and Security





The Results

With an unrivaled attention to detail, a focus on the quality of the project, and a leadership team that understands the importance of communication, we were able to successfully complete this project before the deadline, allowing the scheduled event to go on as planned. This fit-out project is now well recognized among KAFD's offices as being one of the biggest high-end parts of the overall project. The offices are utilized by SIDF's employees, providing them with workspaces that are both highly functional and visually enjoyable.